

AREA CALCULATION

DETAILS OF BLOCKWISE DISTRIBUTION OF AREAS

Sr. No.	Plot No.	Area in M <sup>2</sup>	Plot No.	Area in M <sup>2</sup>	Plot No.	Area in M <sup>2</sup>		
1	S-1	16910.00	9	S-6-B	1210.00	17	S-10	1307.00
2	S-2	8950.00	10	S-6-C	1610.00	18	S-10-A	1337.00
3	S-3	6850.00	11	S-7	65762.00	19	S-11	1629.00
4	S-4	3350.00	12	S-7-A	5000.00	20	S-12	5000.00
5	S-5	1310.00	13	S-8	2310.00	21	S-13	5000.00
6	S-5-A	2310.00	14	S-8-A	5000.00	22	S-14	5000.00
7	S-6	1680.00	15	S-9	5276.00	23	S-15	5000.00
8	S-6-A	2385.00	16	S-9-A	1126.00	24	S-16	1309.38
			S-7	47150.00	25	S-11	3050.00	
			S-7-A	12642.00	26	S-12	4200.00	
			S-8	3600.00	27	S-13	3174.70	
					28	S-14	1176.00	
					29	S-16	2300.00	
					30	S-16/2	1000.00	
					31	S-16/3	1000.00	
					32	S-6/1	1360.00	
					33	S-6/1/2	1005.00	
					34	S-17	1310.00	
					35	S-7/8	2350.00	

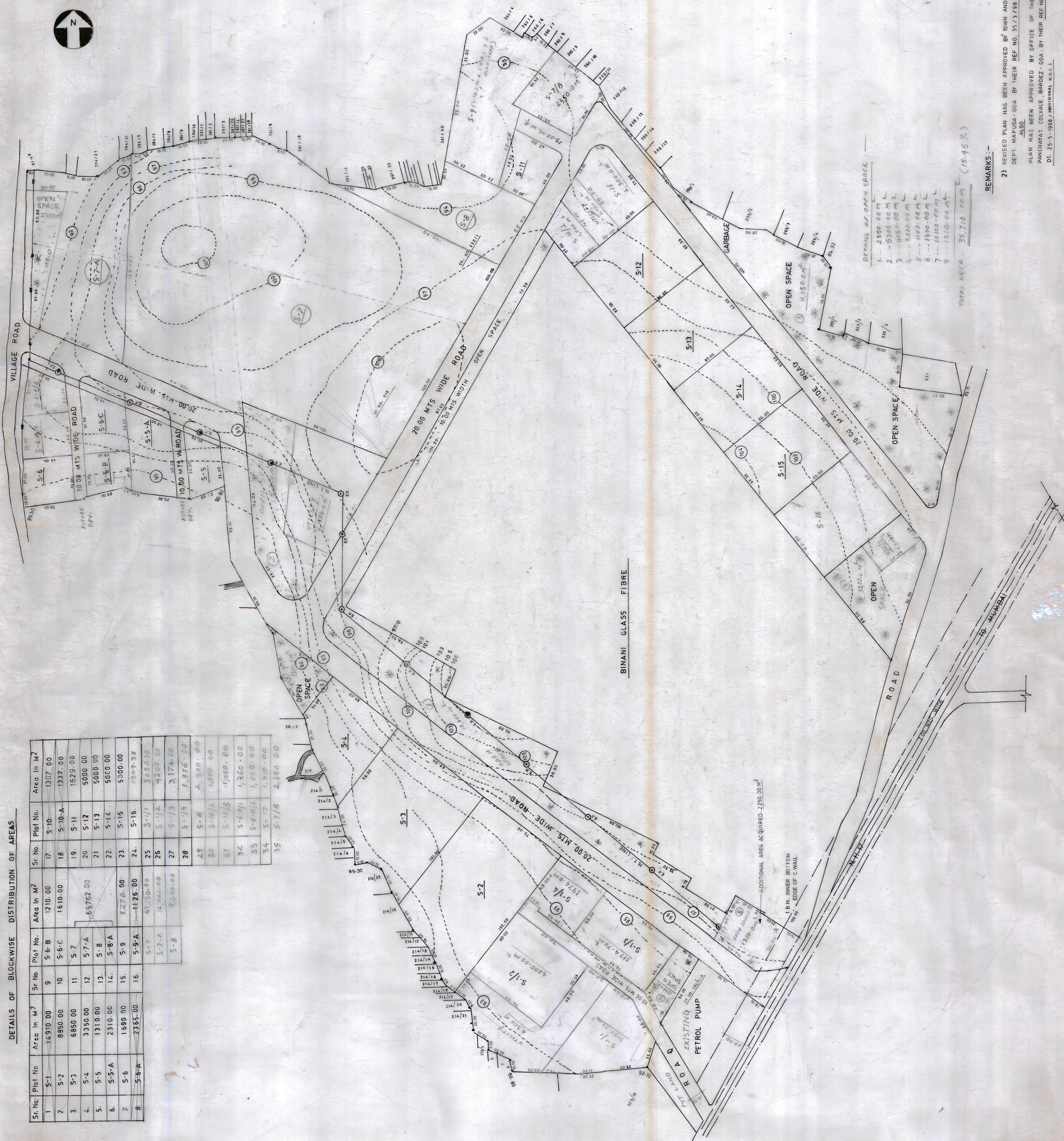

- DETAILS OF OPEN SPACE
- 1 - 2350.00 M
  - 2 - 5300.00 M
  - 3 - 11050.00 M
  - 4 - 3200.00 M
  - 5 - 1100.00 M
  - 6 - 1300.00 M
  - 7 - 10100.00 M
  - 8 - 1310.00 M

TOTAL AREA 35,710.00 M<sup>2</sup> (15.45%)

REMARKS :-

2) REVISED PLAN HAS BEEN APPROVED BY TOWN AND COUNTRY PLANNING DEPT. MAPUSA - GOA BY THEIR REF NO. 35/3/98/281. DT. 8/5/98. ALSO. PLAN HAS BEEN APPROVED BY OFFICE OF THE VILLAGE PANCHAYAT COLVALE, BARDEZ - GOA. BY THEIR REF NO. Y.P.C.F./98-95/113 DT. 25-5-998 (MEMORIAL N.O.C.)

DRAWING :-

REVISED LAYOUT PLAN OF PROPOSED COLVALE INDUSTRIAL ESTATE COLVALE BARDEZ - GOA.

CLIENT :-

AREA STATEMENT

Sr. No.	Description	Area
1	TOTAL PLOT AREA	22,872.00
2	TOTAL AREA IN PLOTS	14,852.48
3	OPEN SPACE	3,577.60
4	UTILITY	1,176.00
5	AREA IN ROADS	2,350.00

NOTE :-

ALL THE DIMENSIONS OF THE PLOTS AND OPEN SPACES ARE WORKED OUT BASED ON THE CURVEY PLAN INDICATING EXISTING FEATURES SUPPLIED BY G.I.D.C. GOVT. OF GOA.

NOTE :- ALL DIMENSIONS ARE IN 'MTRS'

PROJECT ENGINEER  
E. Sathish V. Kuvalekar  
S.I.C. Construction